

1

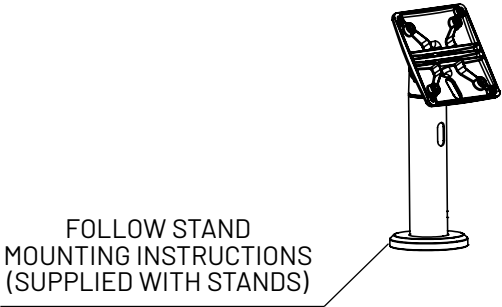

Or

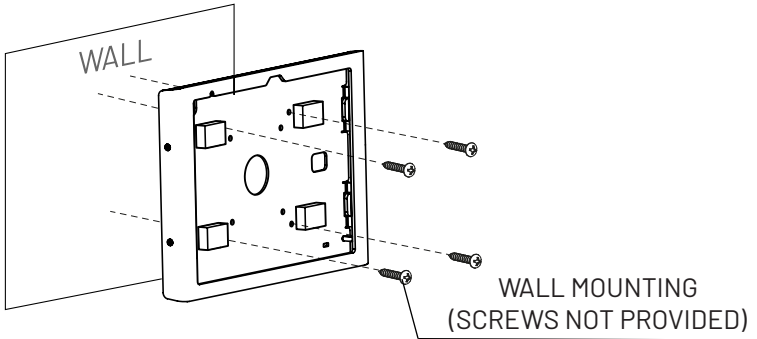

2

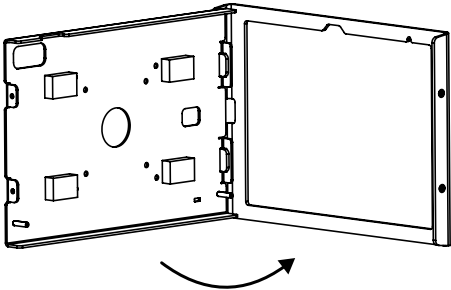

3

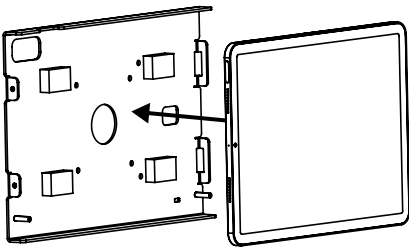

4

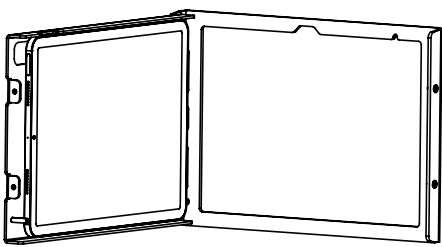

5

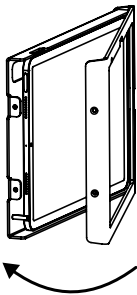

6

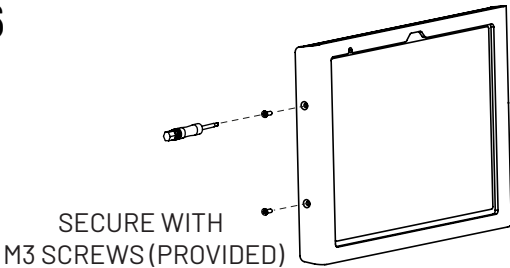

7

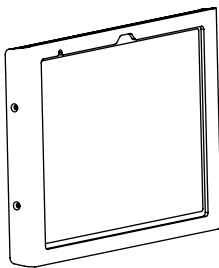

IN THE BOX



Torx Screwdriver



M3x10mm tamper proof screws

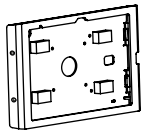

Swell enclosure

1

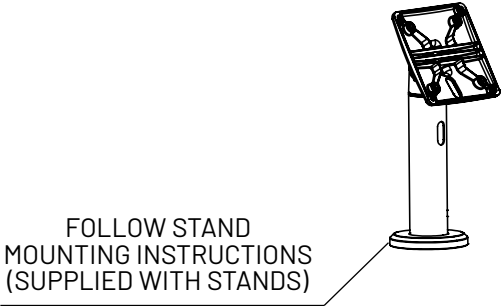

Or

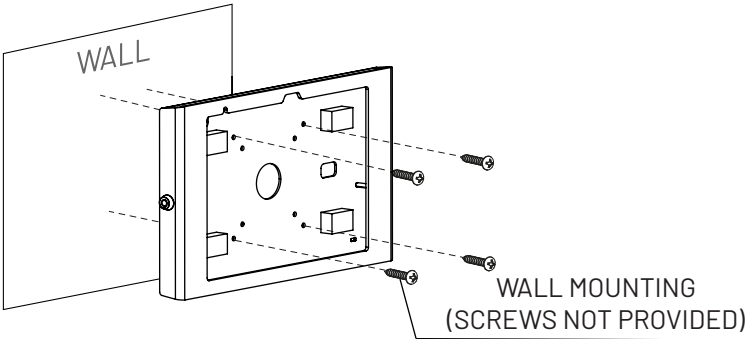

2

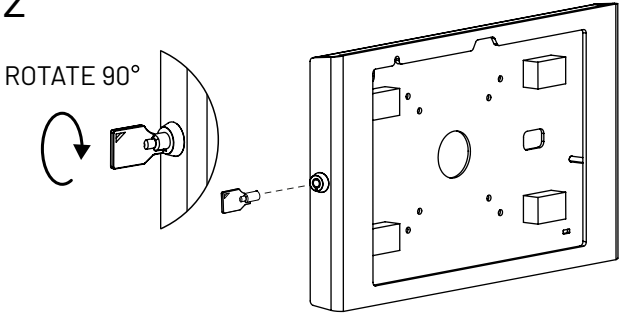

3

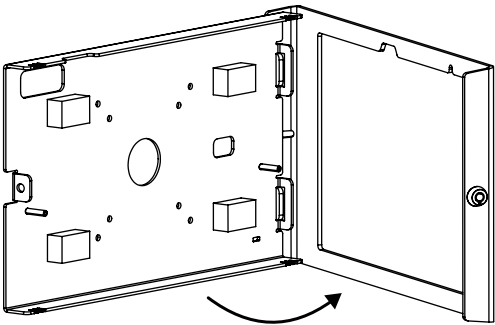

4

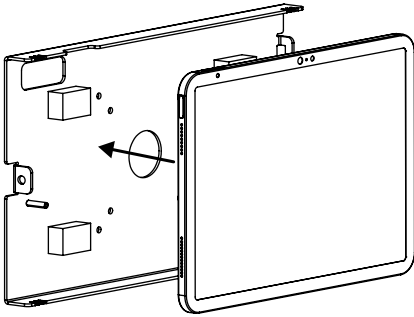

5

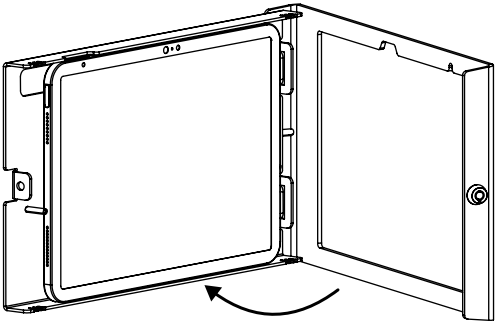

6

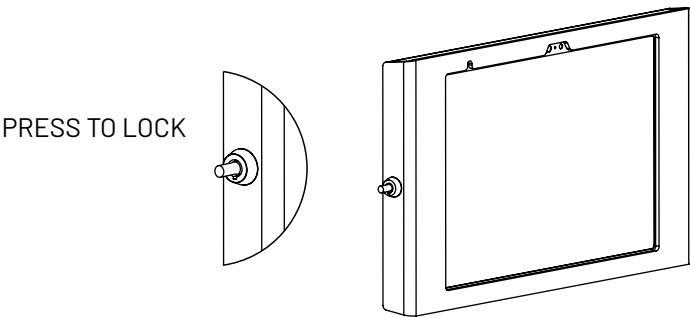

IN THE BOX

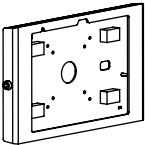

Apex Enclosure

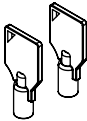

Keys

1



FOLLOW STAND
MOUNTING INSTRUCTIONS

or

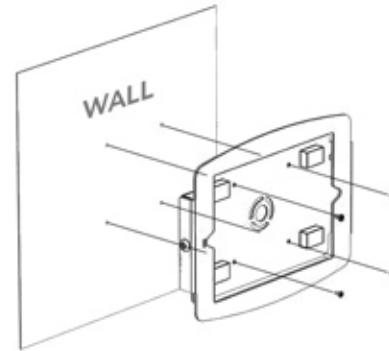

2

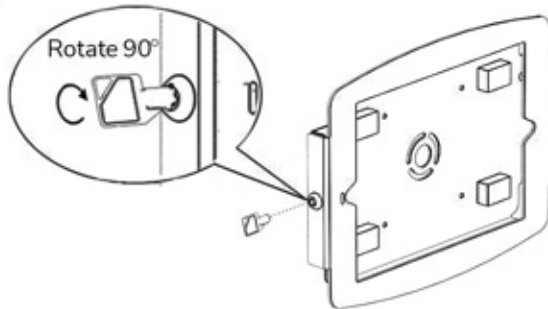

3

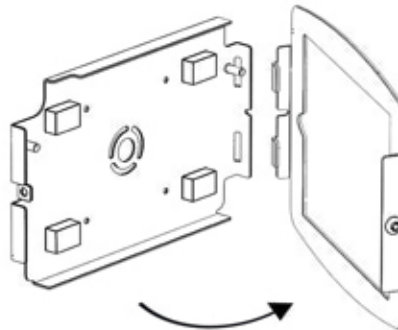

4

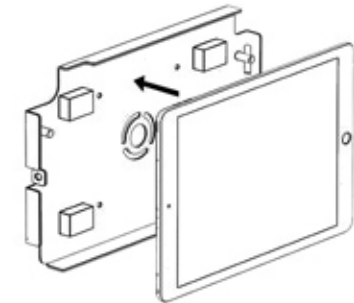

5

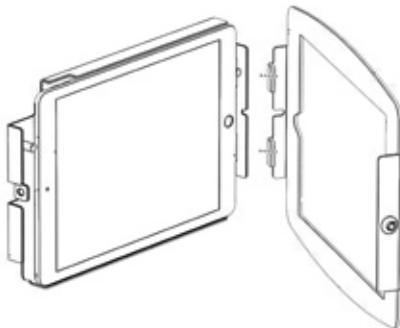

6



7

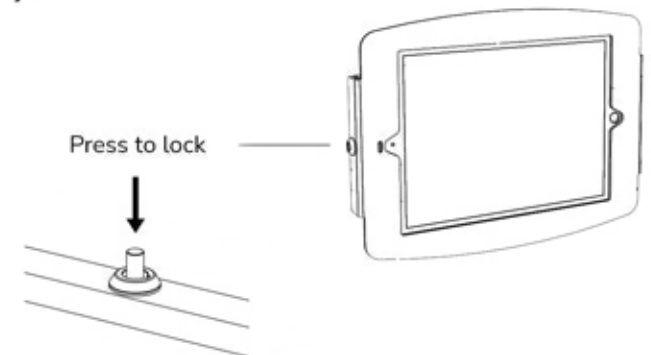

LCD Monitor Arm // Installation Manual

Product name: Articulating Monitor Arm Mount - Reach SKU:660REACH

Product Specification

Sketch											
Item	Monitor size	Weight range (kg)	Lift(mm)	Tilt	Swivel	Pivot	VESA	Packing size (mm)	N.W(kg)	G.W(kg)	Hole layout (mm)
Specification	≤30"	2-10	340	+75°~ -30°	±90°	±90°	75*75	Inner: 475*195*140	Inner: 2.6	Inner: 3.1	28.6x104
		8-20					100*100	Outside: 490*210*440 Inner/Outside: 3/1	Outside: 7.8	Outside: 9.8	

Product Size

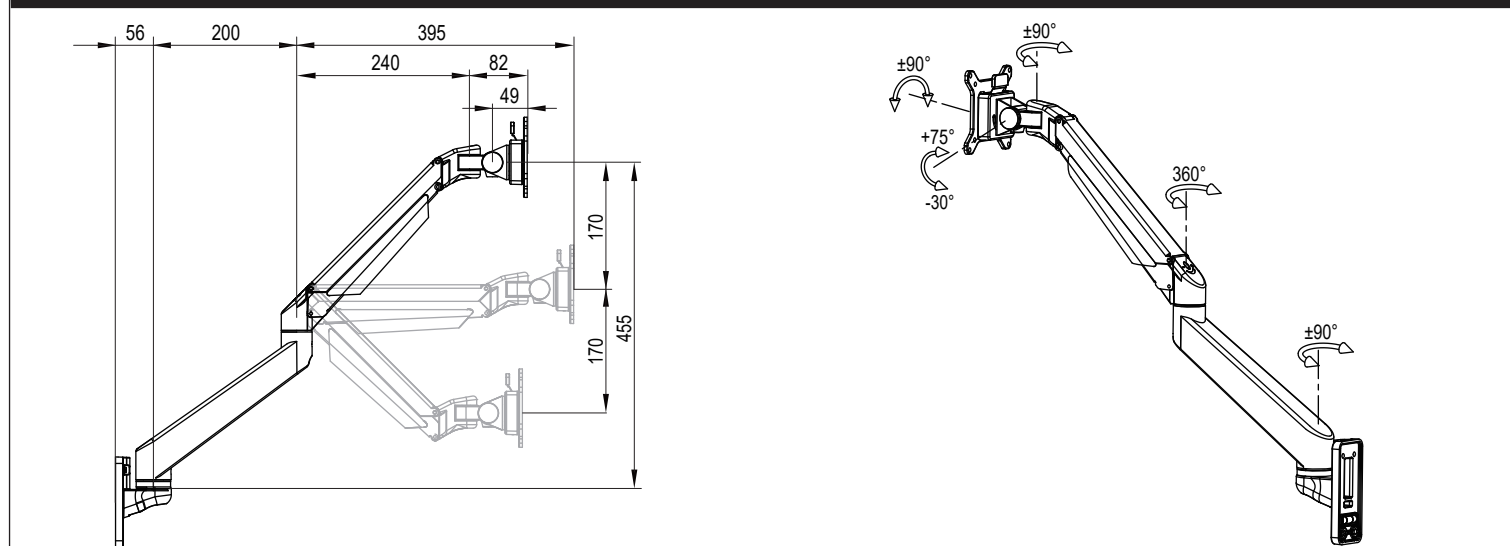

Installation of Wall-fixed Base

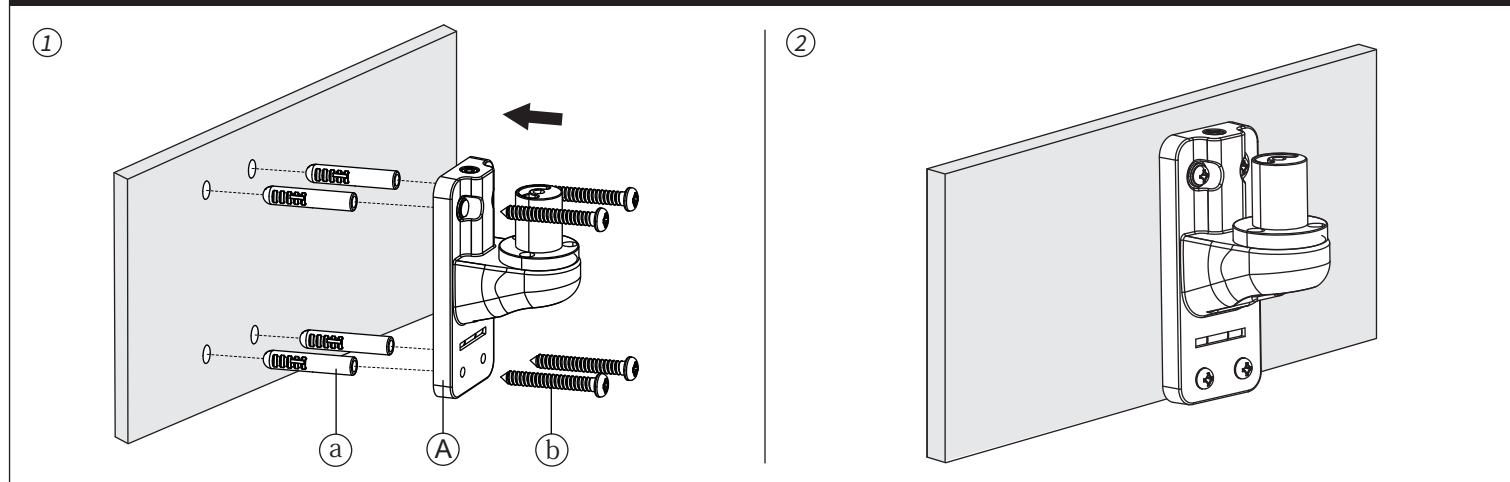

Install Procedure

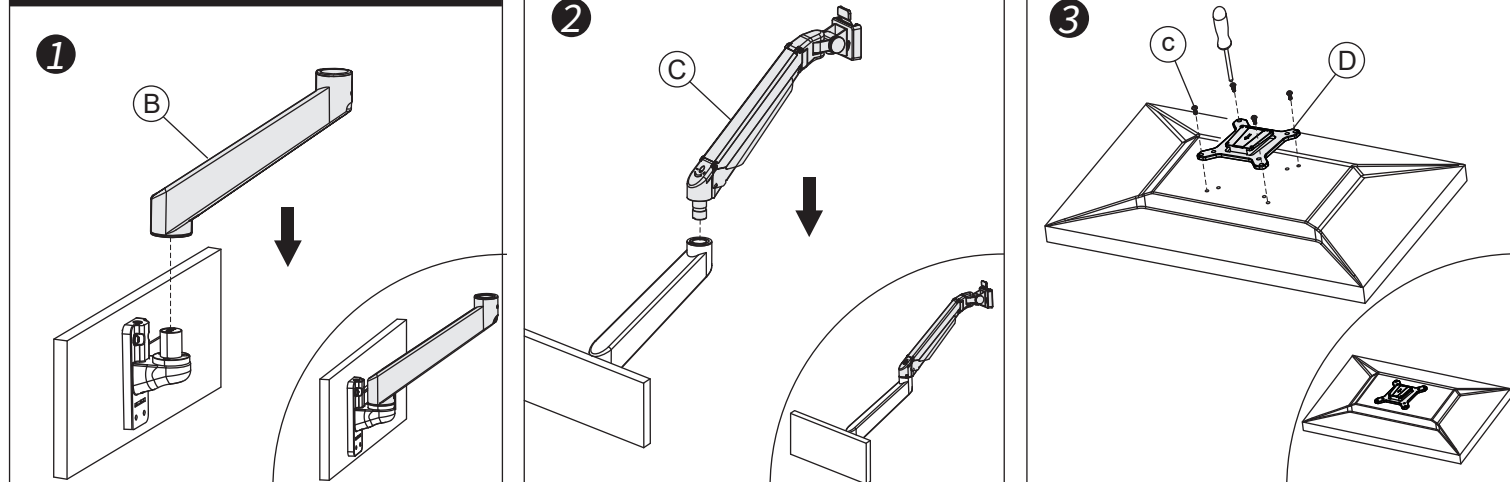

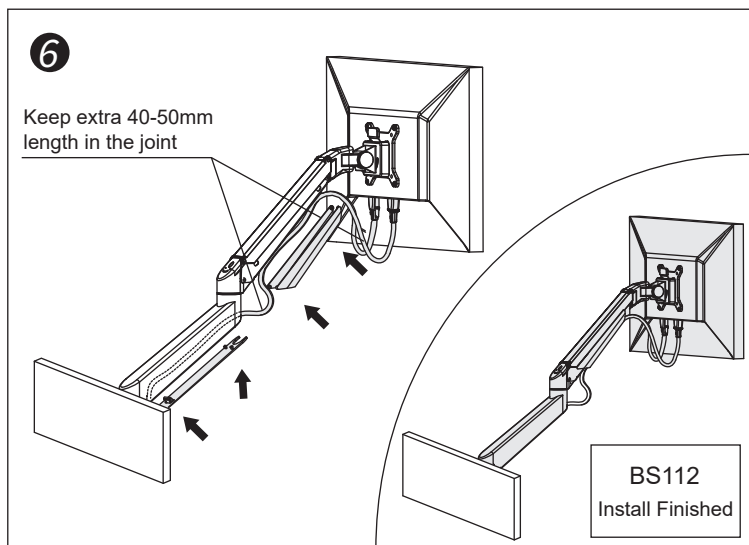
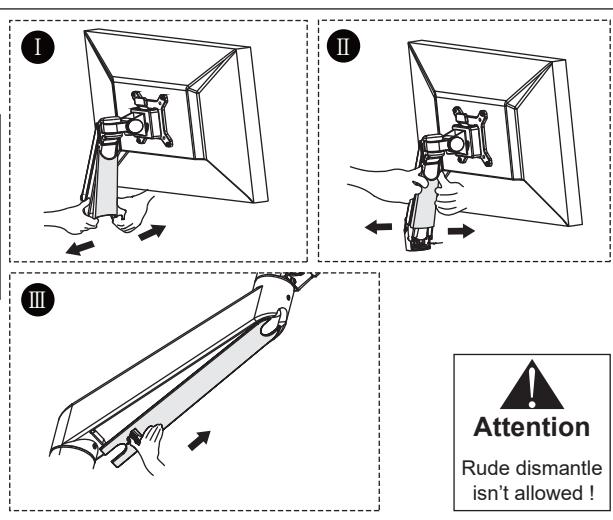
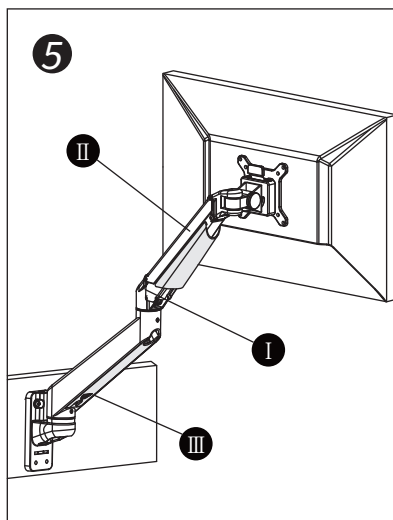
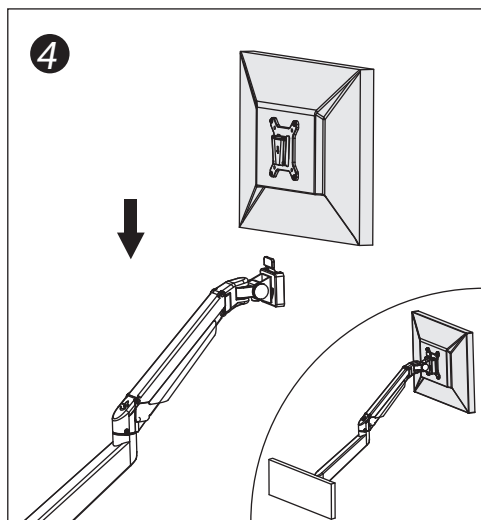

Module List			
No.	Sketch	Specs	Quantity
A			1
B			1
C			1
D			1

Part List			
No.	Sketch	Specs	Quantity
a		Ø10x40	4
b		M6x40	4
c		M4x12	4
d		M4	1
e		M6	1

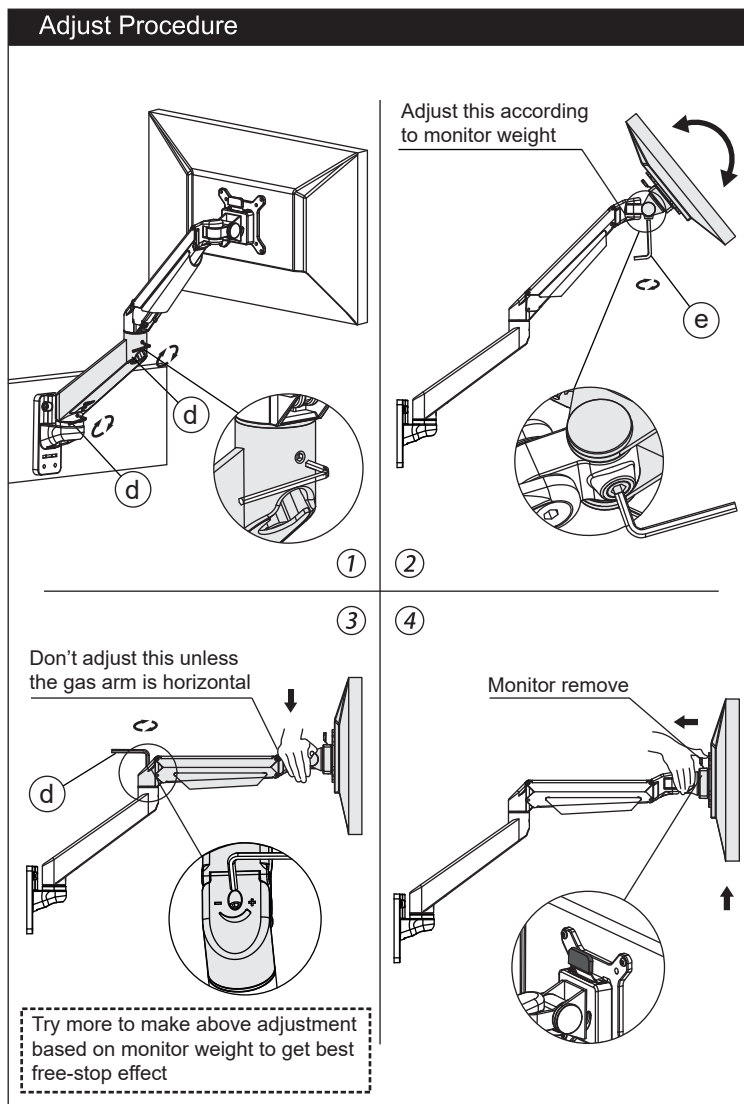

COMPULOCKS