

Grip&Dock Stand (Tilting Dock)

Assembly Instructions

Fixed Mounting

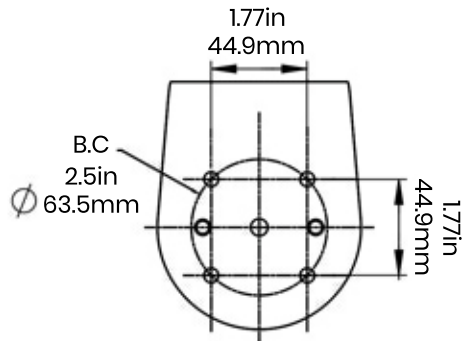

FIXED MOUNTING
PATTERN

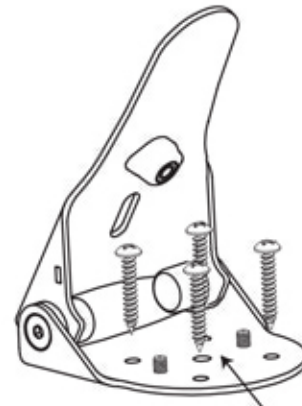

MOUNTING SCREWS
NOT PROVIDED

or

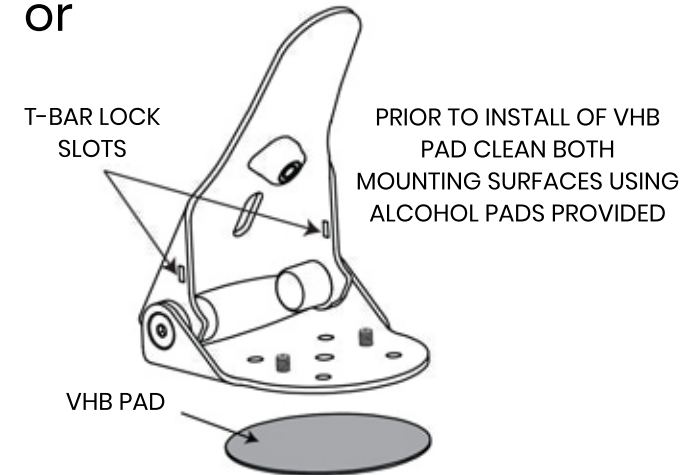

Rotation Mounting

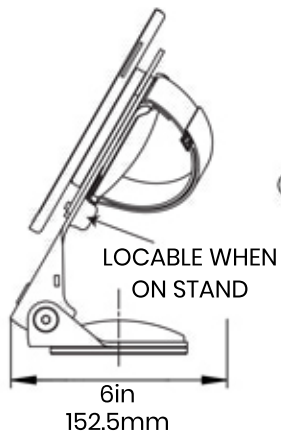

ROTATION CLEARANCE
FOR BACE
WITH 360 DEGREES
OF ROTATION

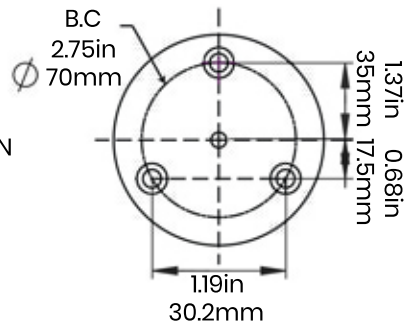

ROTATION MOUNTING
PATTERN

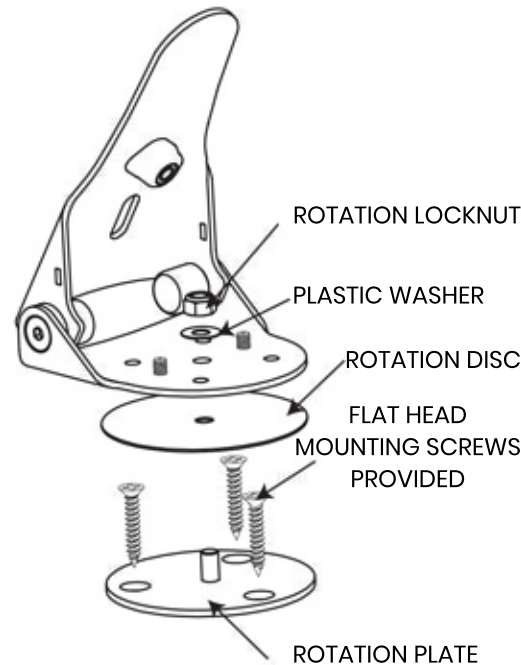

or

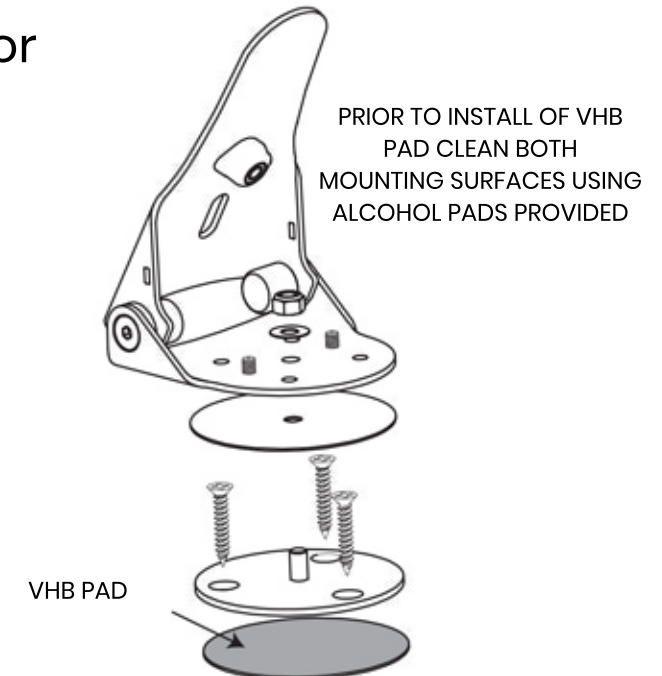

Stand Assembly Rotation

1

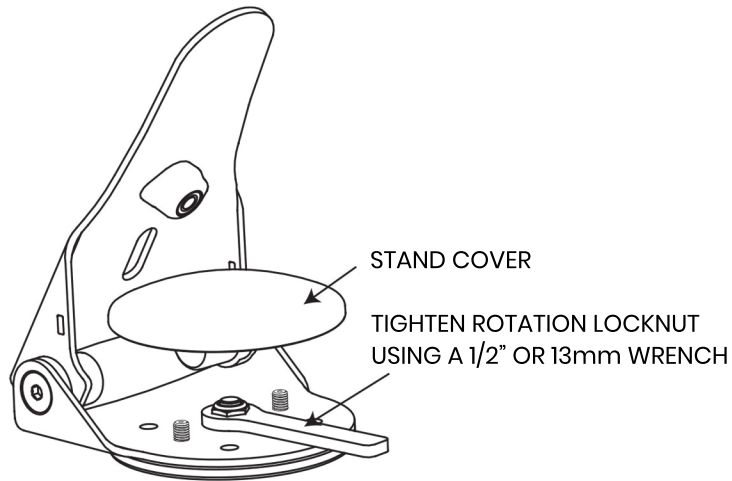

2

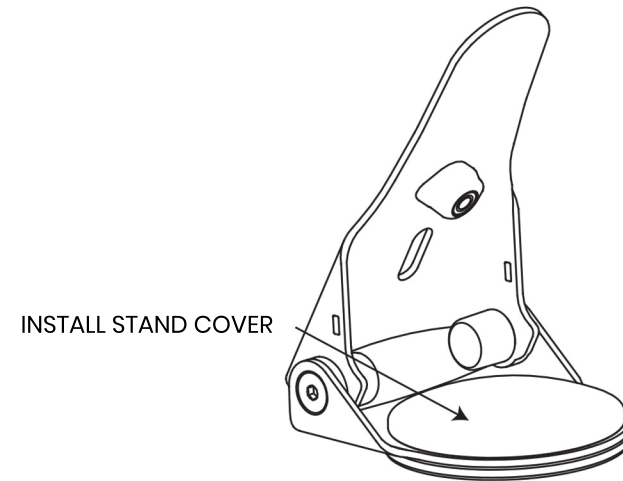

Tablet Bonding

1

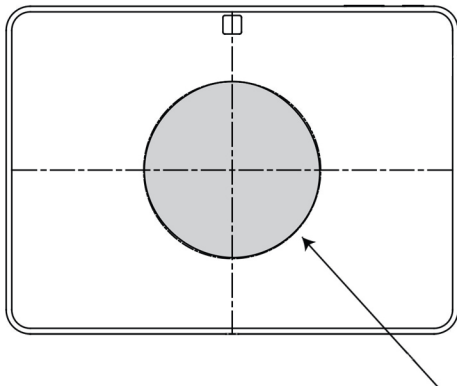

CLEAN A 3"/76.2mm DIAMETER
SURFACE AREA CENTERED ON
BACK OF YOUR TABLET WITH
ALCOHOL PAD PROVIDED

2

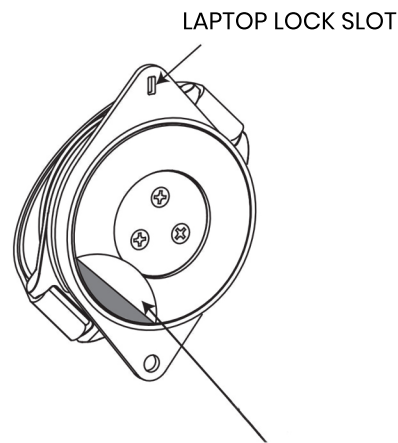

PEEL COVER TO EXPOSE
ADHESIVE PAD

3

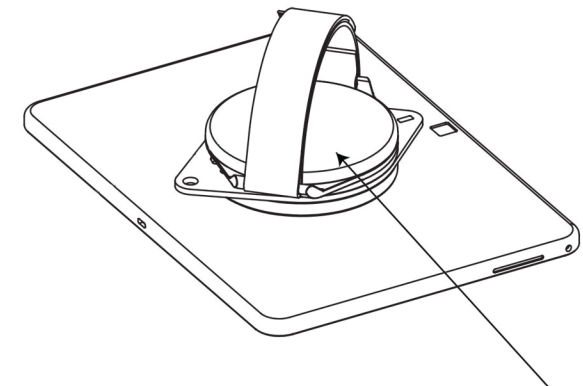

ADHERE GRIP TO BACK OF TABLET
LET BOND SIT FOR 12 HOURS
TO CURE AND BEST PERFORMANCE

Tablet Installation On Stand

1

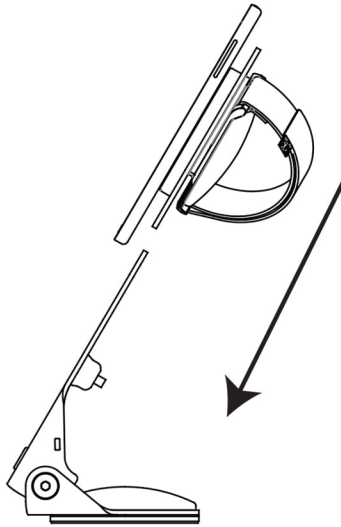

2

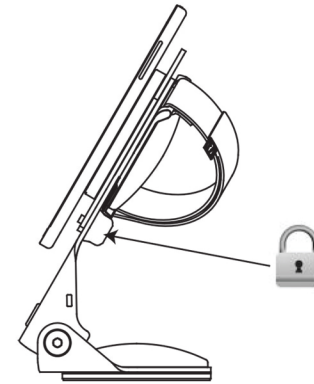

Tablet Removal From Stand

1

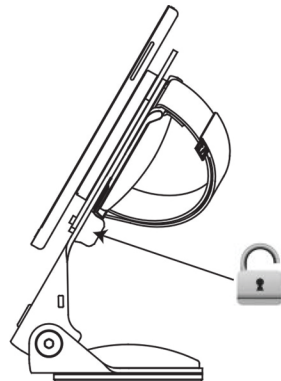

2

